

CHAMBERLAIN®

# LiftMaster®



This product should be used only in connection with garage door openers equipped with photoelectric sensors. If your garage door opener does not have photoelectric sensors, you should consider a replacement garage door opener. Please go to [www.liftmaster.com](http://www.liftmaster.com) to find a local LiftMaster dealer or call 1-800-528-9131.

## MOUNTING RECEIVER

1. Disconnect power to the garage door opener.
2. Fully extend antenna wire below bottom of case as shown.
3. Mount the receiver directly onto the garage door opener with the clips provided (Figure 1).

OR

Attach to a ceiling/inside wall of the garage with connecting bell wire (not provided). Fasten the receiver to the ceiling or inside garage wall with dry wall screws provided (Figure 2).

**NOTE:** Transformer Model 85 or 95 is required if your residential garage door opener is a LiftMaster, Chamberlain or Sears.

## INSTALLATION USING CLIPS

1. Loosen the three terminal screws on the receiver (labeled 1, 2 and 3) (Figure 1).
2. Insert one end of a mounting clip under each terminal. Do not re-tighten at this time.
3. Loosen the three terminal screws on the garage door opener used for push button controls and radio power.
4. Leaving the push button bell wire in place, insert the other ends of the mounting clips under the garage door opener terminal screws.

**NOTE:** If the number sequence of the garage door opener terminals does not match the receiver, turn the receiver around (so back is facing out) and complete the connection.

5. Re-tighten the terminal screws on the garage door opener and receiver.
6. Reconnect power to the garage door opener.

**NOTE:** If the receiver push bar does not light, use Transformer Model 85 or 95.

## INSTALLATION USING BELL WIRE

1. Attach one end of 3-strand bell wire (not provided) to receiver terminals 1, 2 and 3.
2. Connect the other end to the three garage door opener terminals used for push button controls and radio power.
3. Use insulated staples to secure bell wire between receiver and garage door opener (Figure 2).
4. Reconnect power to the garage door opener.

**NOTE:** If the receiver push bar does not light, use Transformer Model 85 or 95.

## INSTALLATION WITH TRANSFORMER

1. With the transformer, use a 2-wire connection only.
2. Attach wire to receiver terminals 1 and 2 and to the garage door opener terminals used for push button control.
3. Plug the transformer into receiver and 120 Volt outlet (Figure 3).

## SECURITY+® UNIVERSAL RADIO CONTROL

MODELS 355LM & 355-2LM\* (315 MHz)

MODELS 535LM & 535-2LM\* (390 MHz)

\*Indicates 2 remote controls are provided

## ⚡ ⚠ WARNING

To prevent possible SERIOUS INJURY or DEATH from electrocution:

- Be sure power is NOT connected BEFORE installing the receiver.

To prevent possible SERIOUS INJURY or DEATH from a moving gate or garage door:

- ALWAYS keep remote controls out of reach of children. NEVER permit children to operate, or play with remote controls.
- Activate gate or door ONLY when it can be seen clearly, is properly adjusted, and there are no obstructions to door travel.
- ALWAYS keep gate or garage door in sight until completely closed. NEVER permit anyone to cross path of moving gate or door.

Figure 1

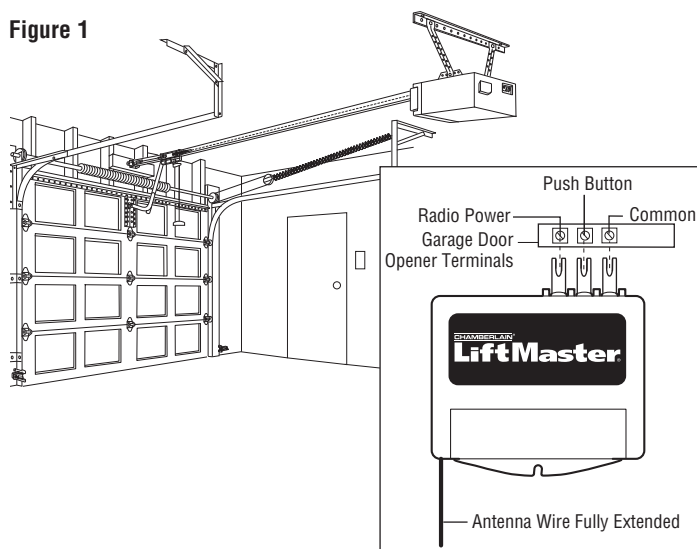

Figure 2

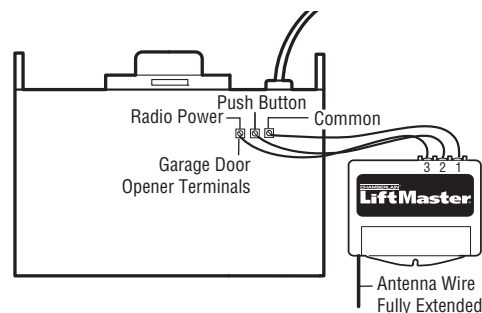
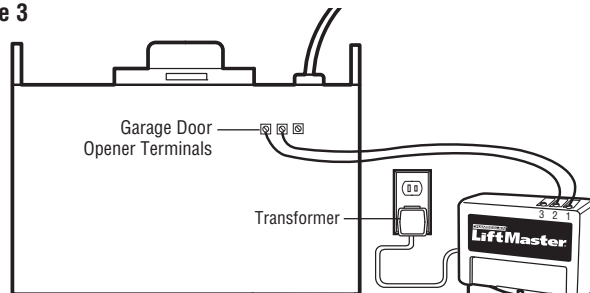

Figure 3



**NOTE:** Transformer Model 85 or 95 is required if your residential garage door opener is a LiftMaster, Chamberlain or Sears.

For more information, please visit [www.devancocanada.com](http://www.devancocanada.com) or call toll free at 855-931-3334

## PROGRAMMING THE REMOTE CONTROL TO THE RECEIVER

With Security+® remote controls, the code between the remote control and the receiver changes with each use, accessing over 100 billion new codes.

You can activate your garage door opener with up to 8 Security+® remote controls and one Security+® Keyless Entry.

1. Pry open the front panel of receiver case with a coin or a screwdriver (Figure 4). Re-connect power to the garage door opener.
2. Press and release the “SMART” button on the receiver. The “SMART” indicator light will glow steadily for 30 seconds (Figure 5).
3. Within 30 seconds, press and hold the button on the hand-held remote control that you wish to operate your garage door opener (Figure 6).

The garage door opener will now operate when the push button on either the receiver or the remote control is pressed.

Repeat steps 2 and 3 for each remote control that will be used to operate the garage door opener.

## TO ERASE ALL REMOTE CONTROL CODES

Press and hold the “SMART” button on the receiver panel until the indicator light turns off (about 6 seconds). All remote control codes are now erased. Then follow the steps above to reprogram each remote control.

## REPLACING THE REMOTE CONTROL BATTERY

The lithium battery should produce power for up to 5 years. To replace battery, pry open case with visor clip or screwdriver as shown. Insert battery positive side up.

Dispose of old battery properly. Replace the battery with only 3V2032 coin cell batteries.

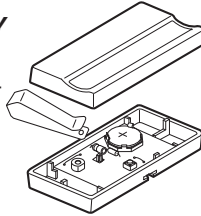

## SET OUTPUT DURATION (COMMERCIAL APPLICATIONS ONLY)

### ⚠ WARNING

To prevent possible SERIOUS INJURY or DEATH, the use of CONSTANT OPERATION on residential openers is PROHIBITED.

For commercial applications, the receiver can be set for either constant or momentary closure on the output contacts. Use of constant closure is prohibited on residential garage door openers because it overrides the safety reversal devices.

With the jumper in the “M” (Momentary) position, the contacts will close for 1/4 second regardless of the length of radio transmission. With the jumper in “C” (Constant) position, the contacts will stay closed as long as the radio continues transmitting.

The receiver is factory set at M.

### SPECIFICATIONS

Output Rating	5 Amps 28 Vac or dc Max.
Power	18V - 30V ~, 30 mA, 60 Hz 18 - 30V ---, 30 mA
RF Frequency	315 MHz (Models 355LM and 355-2LM) 390 MHz (Models 535LM and 535-2LM)

**NOTE:** If the power is other than shown in specifications, Accessory Transformer Model 85 or 95 is required.

### ACCESSORY REMOTE CONTROLS

Series 300	Models 355LM and 355-2LM
Series 60	Models 535LM and 535-2LM (for commercial applications only)
Series 80 and 900	Models 535LM and 535-2LM (for residential applications)

Figure 4

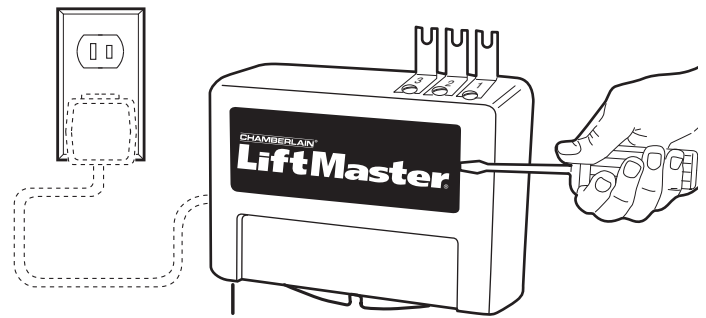

Figure 5

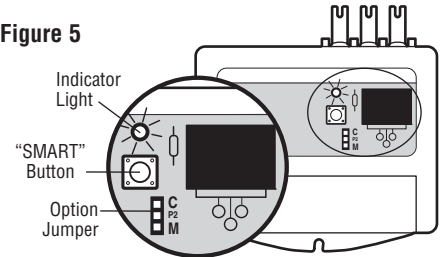
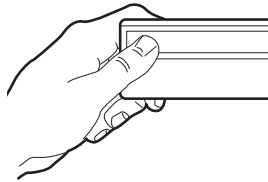

Figure 6



### ⚠ WARNING

To prevent possible SERIOUS INJURY or DEATH:

- NEVER allow small children near batteries.
- If battery is swallowed, immediately notify doctor.

To reduce risk of fire, explosion or chemical burn:

- Replace ONLY with 3V2032 coin batteries.
- DO NOT recharge, disassemble, heat above 100°C (212°F) or incinerate.

**NOTICE:** To comply with FCC and/or Industry Canada (IC) rules, adjustment or modifications of this receiver and/or remote control are prohibited, except for changing the code setting or replacing the battery. THERE ARE NO OTHER USER SERVICEABLE PARTS.

Tested to Comply with FCC Standards FOR HOME OR OFFICE USE. Operation is subject to the following two conditions: (1) this device may not cause harmful interference, and (2) this device must accept any interference received, including interference that may cause undesired operation.

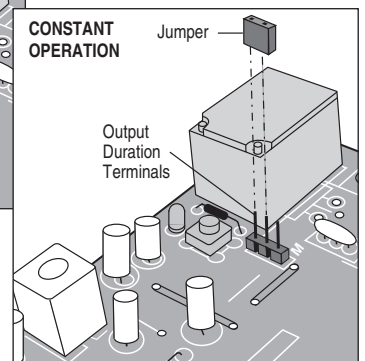
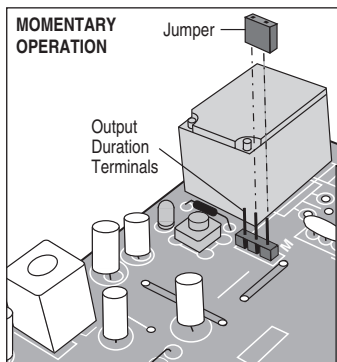

***HOW TO ORDER  
REPAIR PARTS***

**DEVANCO CANADA**

19192 HAY ROAD, UNIT Q  
SUMMERSTOWN, ON K0C 2E0

TOLL FREE: 855-931-3334

[www.devancocanada.com](http://www.devancocanada.com)

**WHEN ORDERING REPAIR PARTS  
PLEASE SUPPLY THE  
FOLLOWING INFORMATION:**

- ✓ PART NUMBER
- ✓ DESCRIPTION
- ✓ MODEL NUMBER