

Installation (Figure 1)

NOTE: For use only with Residential Jackshaft Openers.

- 1** Disconnect all power to the opener if already installed. Disconnect the Standby Power Unit® from the opener if it is installed.
- 2** Determine mounting location for the interface within 3' (.9 m) of opener. Mount and secure with screws and anchors.
- 3** Plug interface into opener.
- 4** Position transformer within 1' (.3 m) of outlet, secure with screws and anchors.
NOTE: If transformer is being secured to ceiling, the transformer must be secured to a ceiling joist.
- 5** Separate low voltage wires. One end of the wire is prepared for convenience. Cut wire to appropriate length and strip 7/16" (11 mm) of insulation from the end of the wire.
- 6** Use one of the stripped wires to connect **COM** screw terminals on the interface and transformer. Use the other stripped wire to connect **24V** screw terminals. (Polarity is not important.)
- 7** Before permanently mounting, reduce slack in cord. Secure with insulated staples.
- 8** Use cable tie to bind power cord from opener. Be sure to keep power cord away from rail and out of the reach of children.
- 9** Plug transformer into the outlet. To reduce the risk of electric shock, your garage door opener has a grounding type plug with a third grounding pin. This plug will only fit into a grounding type outlet. If the plug doesn't fit into the outlet you have, contact a qualified electrician to install the proper outlet.
NOTE: Opener may operate at a slower speed while using this device.

Connect to Standby Power Unit® (SPU) (Not Provided) (Figure 2)

Connect the SPU connector from the SPU to the interface.

NOTE: If connecting to a standby power unit, the interface and SPU must be within 3' (.9 m) of each other.

⚠ WARNING

To prevent possible **SERIOUS INJURY** or **DEATH** from electrocution or fire:

- Disconnect power to opener **BEFORE** proceeding.
- **NEVER** use an extension cord, 2-wire adapter, or change plug in any way to make it fit outlet. Be sure the opener is grounded.

NOTE: If the Smart Control Panel is showing the message "Battery Back-up enabled" or the LCD Backlight is not on under power from the Alternate Power System contact service at 1-800-528-9131.

Figure 1

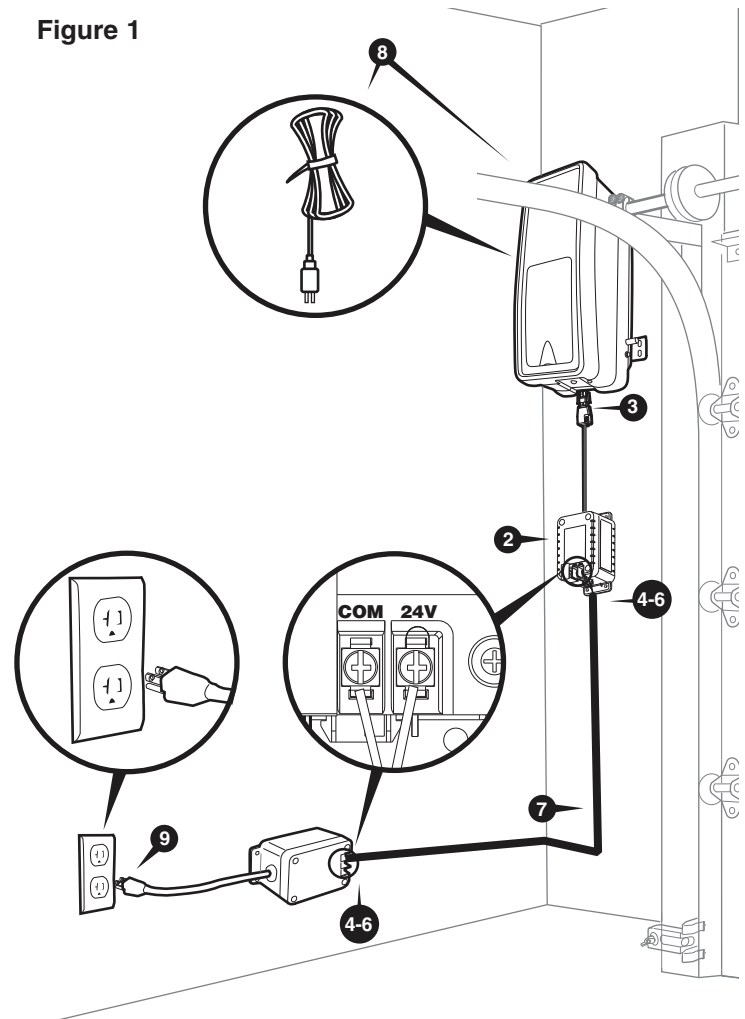
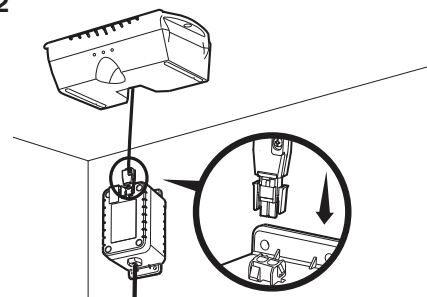

Figure 2



HOW TO ORDER REPAIR PARTS

DEVANCO CANADA

19192 HAY ROAD, UNIT Q
SUMMERSTOWN, ON K0C 2E0

TOLL FREE: 855-931-3334
www.devancocanada.com

**WHEN ORDERING REPAIR PARTS
PLEASE SUPPLY THE FOLLOWING INFORMATION:**

- ✓ PART NUMBER
- ✓ DESCRIPTION
- ✓ MODEL NUMBER