

# Product Specification Sheet

## 02-403P

### PUSH-BUTTON CONTROL STATION

#### STANDARD FEATURES

- 3-button: open, close and stop command.
- 2 NO and 1 NC (stop) contacts.
- Operator Operating Mode: B2 or C2 wiring (momentary contact to open / close or momentary-contact-to-open / stop and constant pressure-to-close).
- Surface mount.
- Exterior use.
- Housing Material: polycarbonate enclosure.
- IP66 Nema type 4, 4X & 13 enclosure.
- Dimensions: 2.68" x 5.35" x 2.44".
- Operation Temperature: -25°C to 70°C (-13°F to 158°F).
- High Pressure Cleaning Resistance: (70 x 105 Pa - 70 bars); distance 3.94" (0.1m); Temperature 131°F (55°C).
- Enclosure Certifications: UL Listed and CSA.
- Contact Certifications: UL and CSA.
- Contact Ratings: 0.1A @ 600VDC, 0.27A @ 250VDC, 0.55A @ 125VDC, 1.2A @ 600VAC, 3A @ 240VAC, 6A @ 120VAC.
- Additive or alternate NO or NC contacts order: PUSH148, PUSH149.
- Includes: control station unit.



#### DIMENSIONS

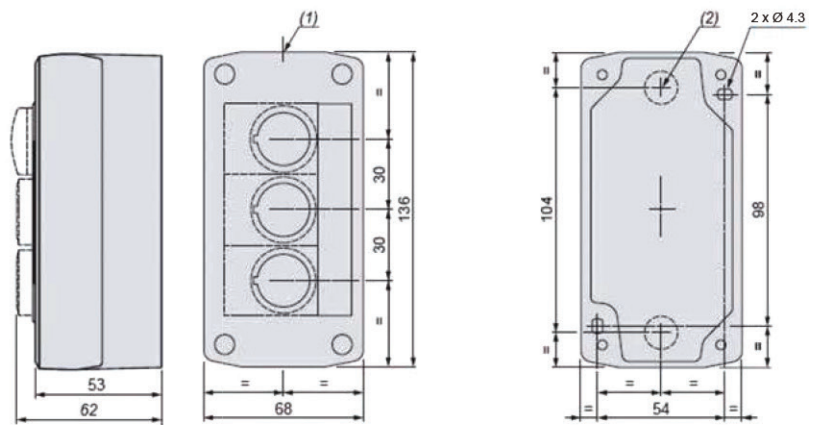

For more information, please visit [www.devancocanada.com](http://www.devancocanada.com) or call toll free at 855-931-3334