

Transmitters

Instructions for models: M3-2312, M3-2314, M3-3313

FEATURES

A family of state-of-the-art transmitters, each transmitter is custom encoded and ergonomically designed to be an integral part of your garage door opener system, with two styles to suit your personal preference:

- Mini (2- or 4-channel)
- Micro (3-channel), the smallest transmitter of its kind.

1. Using the Transmitter

All transmitters come with batteries already installed.

- To open or close garage door, press and hold the button (Mini and Micro transmitters have indicator lights). When garage door begins to move release button.
- To stop the garage door during travel, press and hold button until door stops, then release button.
- To continue the garage door travel after stopping it, press and hold the button. Press button once, the door will travel in the opposite direction.

2. Transmitter Mounting (Figure 1)

The transmitters can be conveniently mounted on the wall (fig. 1A) using the mounting plate (optional) or inside your car using the visor clip (fig. 1B). These two mounting alternatives (fig. 1A and fig. 1B) are available with **Mini** models only. The **Micro** can be used with the key ring attachment (fig. 1C).

Mounting Plate (fig. 1A)

The mounting plate enables you to mount the transmitter easily to the wall or other area.

- Secure the mounting plate to area using screw and anchor (not provided).
- Slide the transmitter into the mounting plate, which will hold it firmly in place.

Visor Clip (fig. 1B)

The visor clip allows for easy mounting of the transmitter to a car visor.

- Snap visor clip into transmitter.

Note: If you do not need the visor clip, install the visor compartment cover.

Key Ring Attachment (fig. 1C)

The key ring attachment permits easy mounting of the **Micro** to a key ring.

- Open the Micro by using small coin.
- Snap in the key ring attachment.
- Close the transmitter.

3. Battery Replacement (Figure 2)

The installation of the battery for **Mini** and **Micro** is the same. When replacing batteries follow the steps below:

- Open the transmitter by using small coin.
- Insert a 3V battery (type CR2032) as shown.
- Close the transmitter.

Note: Replace batteries with same type only.

Figure 1. Mounting Plate & Visor Clip

fig. 1A

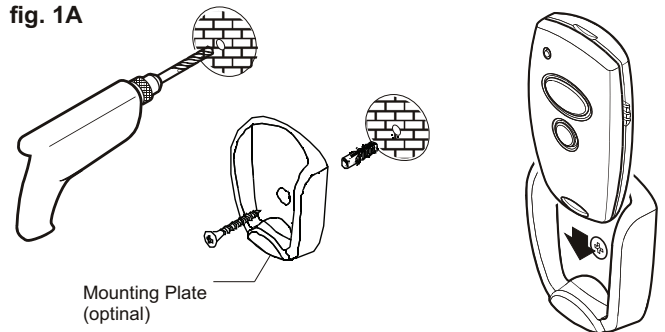

fig. 1B

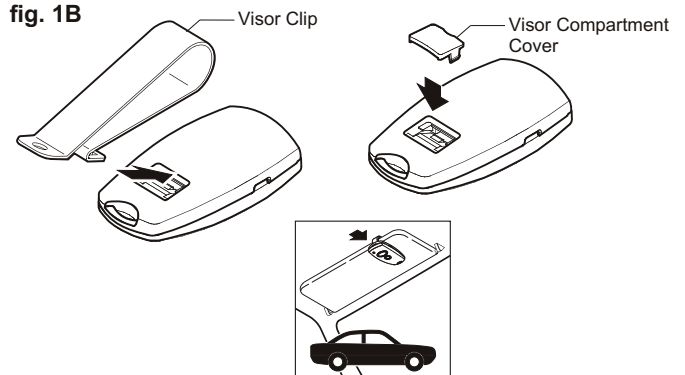

fig. 1C Key Ring Attachment for Micro Transmitter

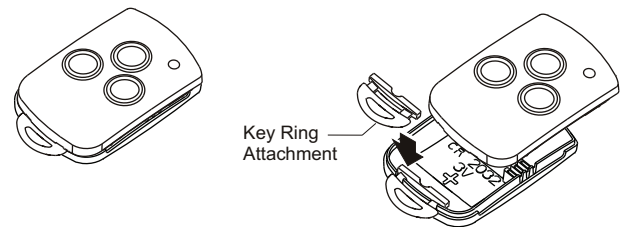
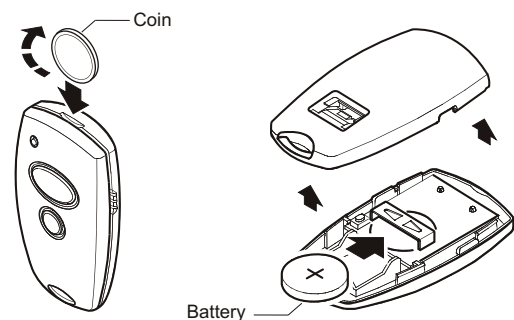

Figure 2. Battery Compartment



Transmitters

Instructions (continued)

4. Multiple Transmitters (Figure 3)

Each transmitter comes factory programmed with random codes. 2-channel transmitters have 2 different random codes, one per button, 3-channel transmitters have 3 different random codes and 4-channel transmitters have 4 different random codes, one per button. Transmitters that are purchased separately as accessories have random codes that must be changed in order to match the code of the "active" transmitter, which you are already using. Below are instructions for transferring an active code from a button on one transmitter to a button of your choice on another transmitter.

- Connect the transmitter with active code to the new transmitter using the programming connector (fig. 3A).
- Press and hold the selected channel button on the transmitter with the active code (fig. 3B). The light in the transmitter illuminates.
- Press and hold the respective channel button on the new transmitter (fig. 3C). The light in the transmitter initially starts blinking and then illuminates continuously after 1-2 sec. Code transfer is completed.
- Programming connector can be removed and both transmitters can now be used to operate the same door.

Note: For multi-button transmitters, be sure to carry out this procedure for all the buttons you desire to use.

5. Changing the Code on Transmitters (Figure 4)

The transmitter factory preset code can be changed as follows:

- Connect the programming connector into the lateral socket of the transmitter to change the code.
- Short one of the outer pins of the programming connector with the middle pin.
- Press and hold the respective channel button. The light will blink rapidly for approx. 5 sec. Release the button after the light illuminates continuously. Then remove the programming connector.

Note: For multi-button transmitters, be sure to carry out this procedure for all the buttons you desire to use.

Figure 3. Multiple Transmitters-Code Transfer

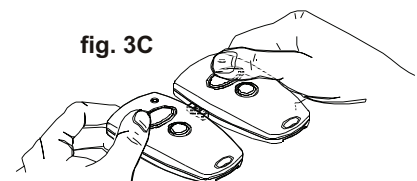
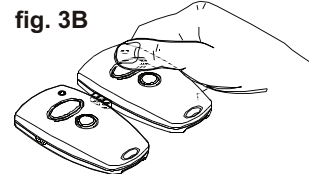
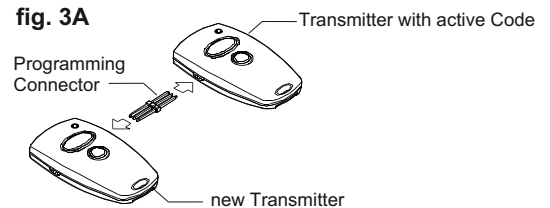
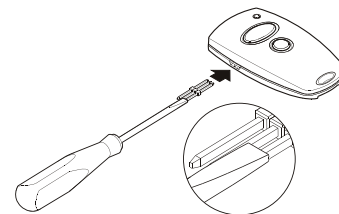

Figure 4. Code Changing



***HOW TO ORDER
REPAIR PARTS***

DEVANCO CANADA

19192 HAY ROAD, UNIT Q
SUMMERSTOWN, ON K0C 2E0

TOLL FREE: 855-931-3334

www.devancocanada.com

**WHEN ORDERING REPAIR PARTS
PLEASE SUPPLY THE
FOLLOWING INFORMATION:**

- ✓ PART NUMBER**
- ✓ DESCRIPTION**
- ✓ MODEL NUMBER**