

# LiftMaster®

## PASSPORT

Model PPV3M

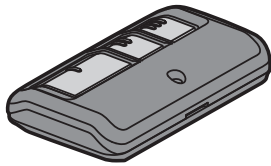

Models PPK3M and PPK3PHM

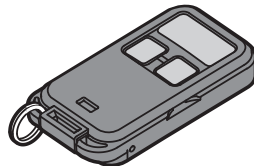

**NOTE:** The images are for reference and your product may look different.

## INTRODUCTION

The Passport MAX is a credentialed remote control. The Passport MAX remote control is a versatile remote control that can be used on access control systems, commercial door operators, gate operators, residential garage door openers, and external receivers (Models PPWR, 850LM, 860LM, STAR1000) that use Security+ 2.0™ or Security+ (315 Mhz and 390 Mhz) technology. The additional buttons on the remote control can be programmed to operate up to 3 additional devices such as garage door openers, light controls, gate operators or access control systems.

**NOTE:** Passport MAX credentialed remote controls are not compatible with CPWR, CPWR3, RFMODKT, and RFMODKT3 Passport products.

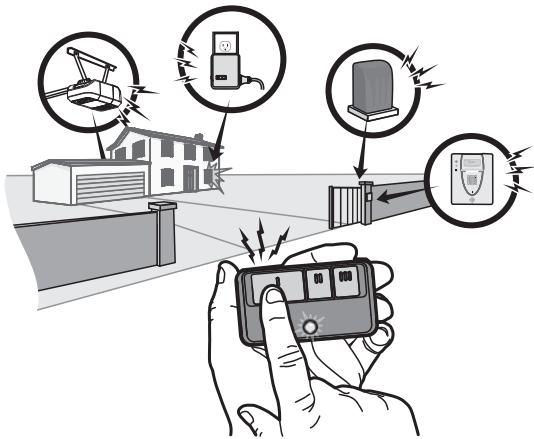

## PROGRAMMING

Depending on your product, the LEARN button or LCD menu will be used to program the remote control.

If programming to an access control system or gated entry, contact your property manager or LiftMaster® dealer for assistance with any programming or operating instructions.

### OPTION 1 – SECURITY+2.0™ PRODUCTS

1. Locate the LEARN button on your product or the PROGRAM button on the LCD (if applicable).
2. Press and release the yellow LEARN button on your product or the PROGRAM button on the LCD. **NOTE:** The button color on commercial products may vary.
3. Press and hold the remote control button you wish to use until your product's programming LED turns off or the lights flash on your product.
4. To test, press the programmed button on the remote control and the product will activate.

## PASSPORT MAX REMOTE CONTROLS

### ⚠ WARNING

To prevent possible SERIOUS INJURY or DEATH from a moving gate or garage door:

- ALWAYS keep remote controls out of reach of children. NEVER permit children to operate, or play with remote controls.
- Activate gate or door ONLY when it can be seen clearly, is properly adjusted, and there are no obstructions to door travel.
- ALWAYS keep gate or garage door in sight until completely closed. NEVER permit anyone to cross path of moving gate or door.

### OPTION 2 – SECURITY+ PRODUCTS (315 Mhz and 390 Mhz)

1. Locate the Program button on the remote control.

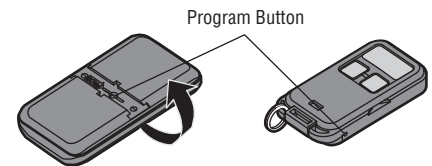

2. To enter the programming mode on the remote control, press the program button until the LED on the front of the remote control turns on.
3. Press and release the remote control button you wish to use:
  - 2 times if your product is 315 MHz (Purple LEARN button)
  - 3 times if your product is 390 MHz (Red/Orange LEARN button)

**NOTE:** The button color on commercial products may vary.

4. Exit programming mode by pressing any remote control button except the button that was just programmed.
5. For LEARN button:

- Press and release the LEARN button on your product

For LCD:

- Press the navigation button below "MENU" to view the Features menu on the LCD. Use the navigation buttons to scroll to "PROGRAM". Select "REMOTE" to program from the program menu.

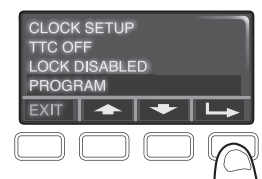

6. Press and hold the remote control button you programmed in Step 3 until your product's programming LED turns off or the lights flash on your product.
7. To test, press the programmed button on the remote control and the product will activate.

## PROGRAMMING (CONTINUED)

### OPTION 3 – RE-PROGRAMMING FOR SECURITY+2.0™ PRODUCTS

1. Locate the Program button on the remote control.
2. To enter the programming mode on the remote control, press the program button until the LED on the front of the remote control turns on.
3. Press and release the remote control button you wish to use:
  - 1 time for SECURITY+2.0™ product (Yellow LEARN button).
4. Exit programming mode by pressing any remote control button except the button that was just programmed.
5. Press and release the yellow LEARN button on your product or the PROGRAM button on the LCD. **NOTE:** *The button color on commercial products may vary.*
6. Press and hold the remote control button you programmed in Step 3 until your product's programming LED turns off or the lights flash on your product.
7. To test, press the programmed button on the remote control and the product will activate.

## HOW TO USE THE REMOTE CONTROL

Press and hold the button down until the door or gate starts to move. For key chain remote controls with a proximity sensor, hold the remote control 1-2" away from the reader face and wait for a confirmation beep or LED from the reader. Operation of the proximity sensor varies depending on the access control system. For additional information refer to the owner's manual for the access control system.

## THE REMOTE CONTROL BATTERY

To replace battery, open the case as shown. Insert battery positive side up (+). Replace the battery with only 3V CR2032 coin cell battery. Dispose of old battery properly.

### VISOR REMOTE

Pry open the case first in the middle (1), then at each side (2 and 3) with the visor clip.

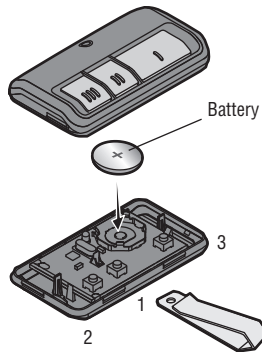

### KEY CHAIN REMOTE

Pry open the case with a screwdriver blade.

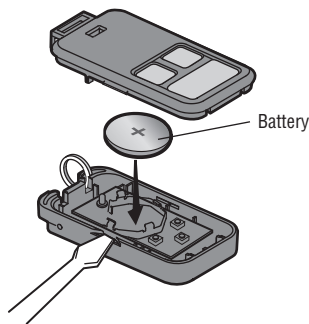

## ⚠ WARNING

To prevent possible SERIOUS INJURY or DEATH:

- NEVER allow small children near batteries.
- If battery is swallowed, immediately notify doctor.

To reduce risk of fire, explosion or chemical burn:

- Replace ONLY with 3V CR2032 coin batteries.
- DO NOT recharge, disassemble, heat above 212° F (100° C) or incinerate.

NOTICE: To comply with FCC and or Industry Canada rules (IC), adjustment or modifications of this receiver and/or transmitter are prohibited, except for changing the code setting or replacing the battery. THERE ARE NO OTHER USER SERVICEABLE PARTS.

Tested to Comply with FCC Standards FOR HOME OR OFFICE USE. Operation is subject to the following two conditions: (1) this device may not cause harmful interference, and (2) this device must accept any interference received, including interference that may cause undesired operation.

## REPLACEMENT PARTS

3V CR2032 Lithium battery .....	10A20
Visor Clip .....	29B137

## ONE YEAR LIMITED WARRANTY

The Chamberlain Group, Inc. warrants to the first consumer purchaser of this product that it is free from defect in materials and/or workmanship for a period of 1 year from the date of purchase.

## HOW TO ORDER REPAIR PARTS

### DEVANCO CANADA

19192 HAY ROAD, UNIT Q  
SUMMERSTOWN, ON K0C 2E0

TOLL FREE: 855-931-3334

[www.devancocanada.com](http://www.devancocanada.com)

**WHEN ORDERING REPAIR PARTS  
PLEASE SUPPLY THE  
FOLLOWING INFORMATION:**

- ✓ PART NUMBER
- ✓ DESCRIPTION
- ✓ MODEL NUMBER